

Electric instantaneous water heaters

KDE / KDEZ Bonus electronic

Reliable water heater with electronic control system



KDEZ

Metal case with extra resistance to prevent any damage. Perfect for public buildings.

Application

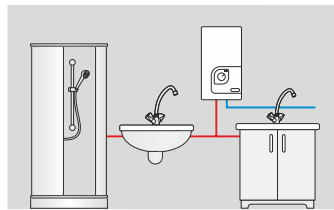

from 12kW

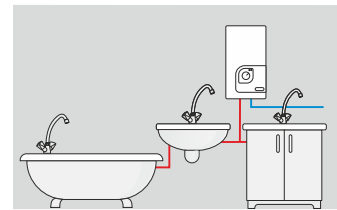

from 18kW

Most important advantages



Copper shielded heating elements
Reliable technology ensures long life, resistance to water decay and air bubbles.



Electronic control system
Ensures stability and smooth regulation of water temperature from 30°C - 60°C.



Water flow sensor
Sensor operates at very low pressure 0,1MPa and water flow as little as 2,5 l/min.

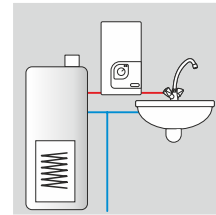

Can work on already preheated water. Inlet water temperature up to 70°C.

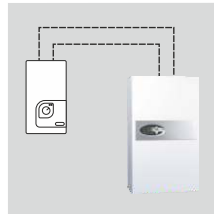

Priority switch
Cooperation with another electric high power consumption appliance.

Dimensions

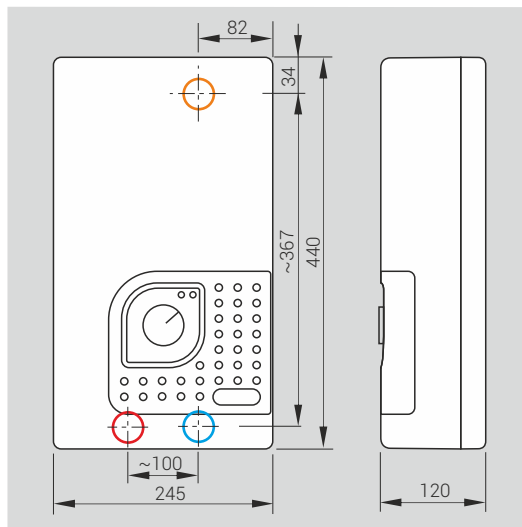

Supply water pressure	0,12 - 0,6 MPa
Inlet and outlet section	Gz 1/2"*
Safety class	IP 25
Energy efficiency class	A

* Inlet and outlet pipes connected to the heater must be made of copper or steel

- Electric cable connection point
- Cold water inlet
- Hot water inlet

Technical data

Type	Rated power / Rated voltage	Rated current (A)	Min. connecting wires section (mm ²)	Efficiency (Δt=30°) (l/min.)
KDE-09 BONUS	9 kW / 400V 3~	3x13,0	4 x 1,5	4,3
KDE-12 BONUS	12 kW / 400V 3~	3x17,3	4 x 2,5	5,8
KDE-15 BONUS	15 kW / 400V 3~	3x21,7	4 x 2,5	7,2
KDE-18 BONUS	18 kW / 400V 3~	3x26,0	4 x 4	8,7
KDE-21 BONUS	21 kW / 400V 3~	3x30,3	4 x 4	10,1
KDE-24 BONUS	24 kW / 400V 3~	3x34,6	4 x 6	11,6
KDE-27 BONUS	27 kW / 400V 3~	3x39,0	4 x 6	13,0